

NOTES:  
 1 ALL DIMENSIONS SHOWN ARE FINISH OPERATIONAL DIMENSIONS WHICH INCLUDE RESIDUAL COATINGS UNLESS OTHERWISE SPECIFIED.

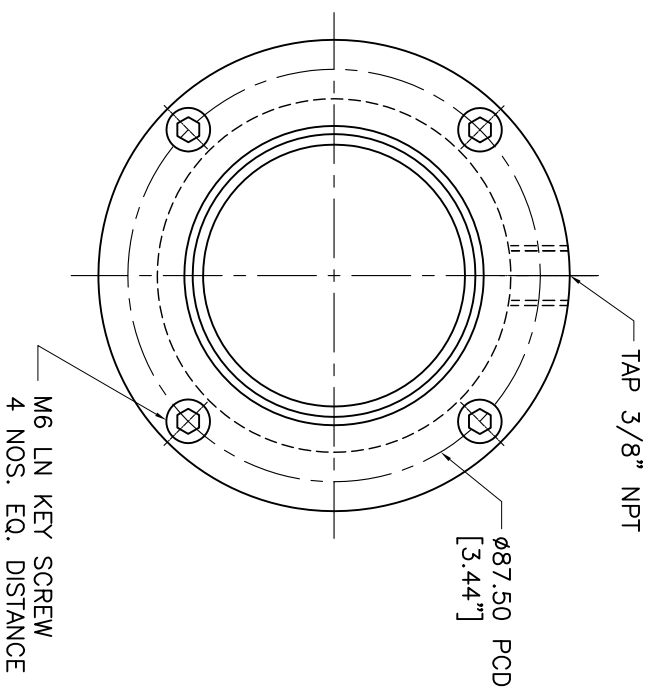
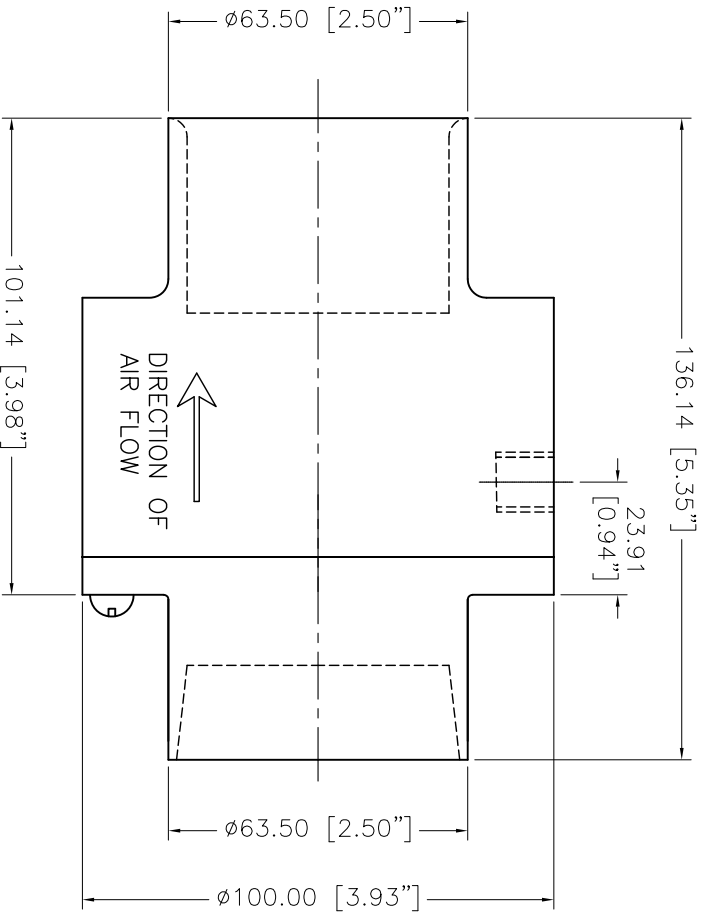

THIRD ANGLE PROJECTION	
MATERIAL	S.S. 304
FINISH	

REQUIREMENTS UNLESS OTHERWISE SPECIFIED	GENERAL
1. DIMS ARE IN INCHES (MM)	
2. DIMENSIONS ARE TO BE MAINTAINED IN ACCORDANCE WITH ANSI Y14.5 (1982)	
3. MACHINE FINISH 125 MICRO INCH RMS	
4. INTERNAL RADI R015	
5. BREAK SHARP CORNERS .005 TO .015	
LIMITS	
1. LINEAR DIMS	.005
2. ANGLES	± .010
3. RADIUS	± .010
4. HOLES IN ACCORDANCE WITH AND 10387	

CONTRACT NUMBER	CLIENT
CONTRACTOR	
DATE	10/06/2013
DESIGN	LESS
PROJECT	D.A.
STRESS	MANUFACTURING
THERMAL	MATERIALS
MECHANISM	ELECTRICAL

TITLE	NEX FLOW AIR PRODUCTS CORP. 10320 YONCE STREET, UNIT 38B-220, RICHMOND HILL, ON L4C 3C7 TEL: (416) 410-1313 & FAX: (416) 410-1806 WWW.NEX-FLOW.COM	
SCALE	1:1	300055
SIZE	C	P
DATE CODE	DWG NO.	REV

OUTLINE DRAWING OF  
 2.5" S.S.304 RING VAC

M6 LN KEY SCREW  
 4 NOS. EQ. DISTANCE

TAP 3/8" NPT

Ø87.50 PCD  
 [3.44"]