

1/2" NPT
INLET

Ø5.2" [Ø133.3]

M6 X 6 HOLES ON
Ø4.9" [Ø123.3]
PCD

Ø4.0" [Ø101.6]
Ø3.7" [Ø93.6]
THRU THROAT DIAMETER

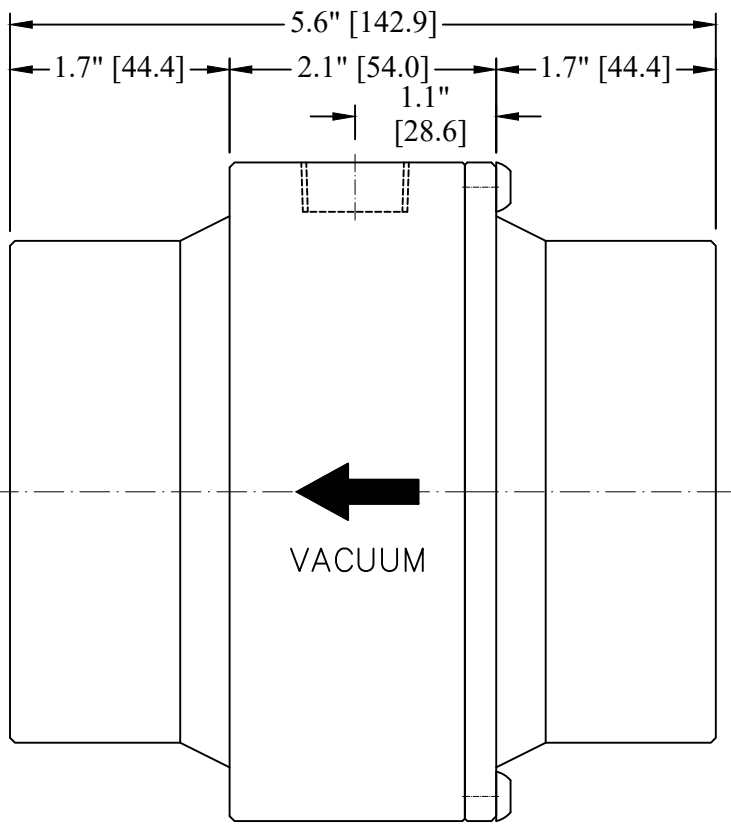

VACUUM

PROPRIETARY
REPRODUCTION OR DISTRIBUTION
WITHOUT WRITTEN CONSENT OF
NEXFLOW™ IS PROHIBITED.

THIRD ANGLE PROJECTION	
MATERIAL	HIGH TEMPERATURE STAINLESS STEEL
FINISH	BUFFING

REQUIREMENTS—UNLESS OTHERWISE SPECIFIED	
GENERAL	
1. DIMS ARE IN INCHES (MM).	
2. DIMENSIONING AND TOLERANCING IN ACCORDANCE WITH ANSI Y14.5 (1982)	
3. MACHINE FINISH 125 MICRO INCH RMS	
4. INTERNAL RADI .015" (0.4)	
5. BREAK SHARP CORNERS 0.005" (0.1) TO 0.015" (0.4)	
LIMITS	
1. LINEAR DIMS.	
.XXX = .005" (0.1)	
.XX = .010" (0.2)	
.X = .030" (0.8)	
2. ANGLES = ± 1/2°	
3. RUNOUT .010 TIR	
4. HOLES IN ACCORDANCE WITH AND 10387	

CONTRACT NUMBER	-
CLIENT	-
CONTRACTOR	-
DESIGN	CHIRAG.S
DATE	25/04/2021
CHECKED	LES
PROJECT	Q.A.
STRESS	-
MANUFACTURING	-
THERMAL	-
MATERIALS	-
MECHANISM	-
ELECTRICAL	-

NEX FLOW AIR PRODUCTS CORP. 10520 YONGE STREET, UNIT 35B-230, RICHMOND HILL, ON L4C 3C7 TEL.: (416) 410-1313 & FAX: (416) 410-1806 www.nex-flow.com			
TITLE 4" HIGH TEMPERATURE STAINLESS STEEL RING VAC			
SIZE	CAGE CODE	PART NO	RELEASE
C	-	30007HTS	P 1
SCALE	1:1	DWG NO	SHEET 1 OF 1